

## Light Bi-Bloc Storage Systems

### Light Bi-Block combinations

Shelving with tile planks

Shelving with catwalk

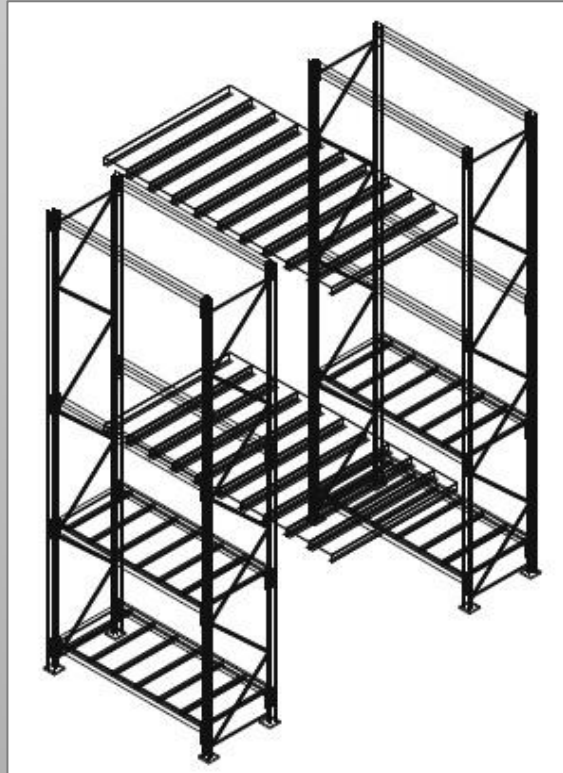
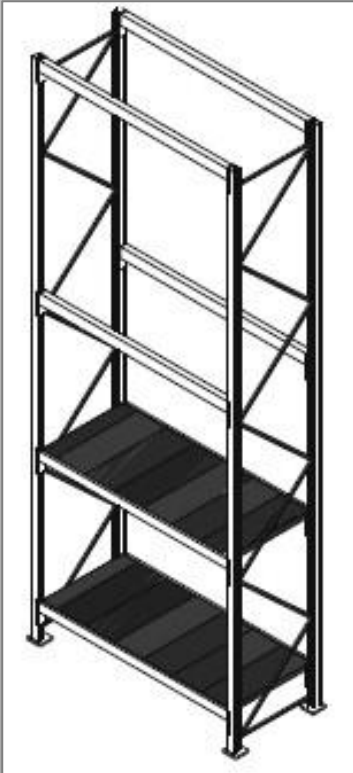

### Components

Medium-load capacity system for containers or bulk goods. It can be completed with catwalks to obtain multi-functional installations for intensive use. It can be also combined with automated storage solutions;

### Material

#### Uprights, beams:

Sendzimir galvanized steel S350 GD UNI EN 10326

#### Stringers/diagonals, tiles:

Sendzimir galvanized steel S280 GD UNI EN 10326

#### Base plates:

steel S235 JR UNI EN 10025 – electro-galvanized



## Components

The permitted load is understood as uniformly distributed over the two abutment uprights. Unbalanced loads over the tunnel length must be carefully studied in advance. Being "H" - the height of the first beam from the floor, assume H as pitch distance between the next beams in case it might be higher. In order to ensure longitudinal stability, at least 2 pairs of beams must be present in vertical direction (3 pairs in case of jointed shoulders). You need to exclude the load over the beams fixed into the round when determining the type of profiles.

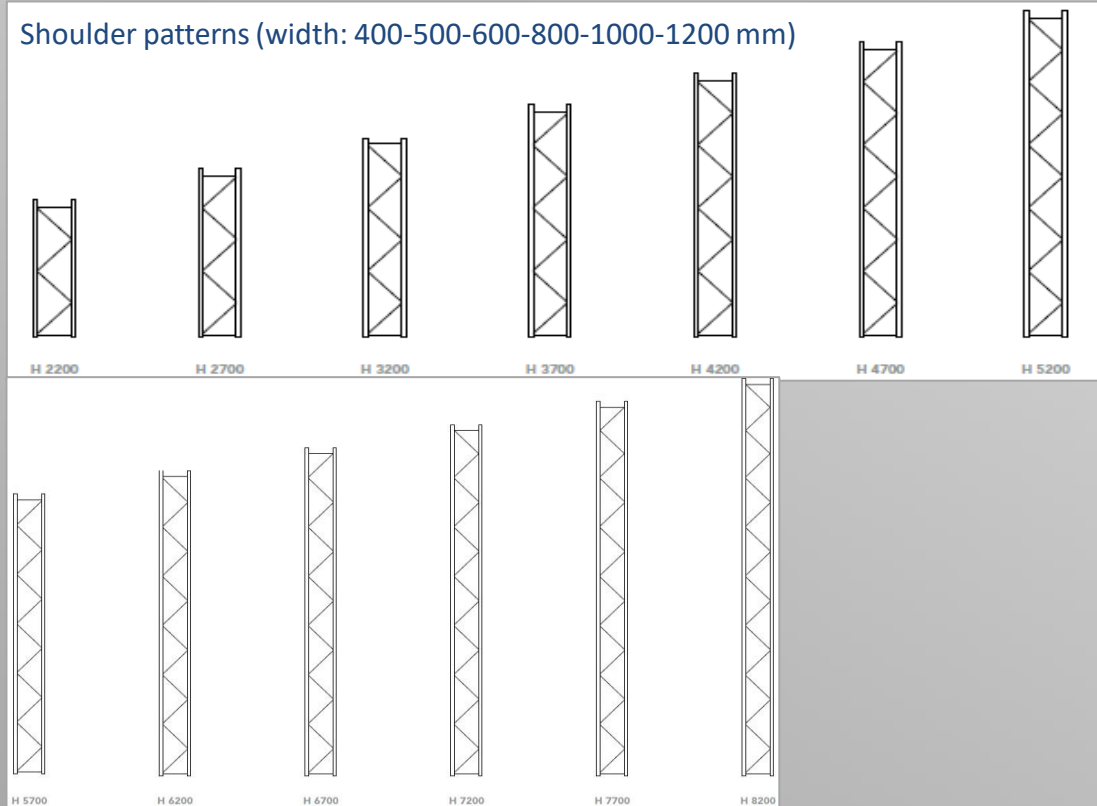

## Cross beams

Abutments width	a (mm)	A (mm)	Weight (kg)	a (mm)	A (mm)	Weight (kg)
400	303	333	0,19	585	615	0,34
500	403	403	0,24	642	672	0,38
600	503	533	0,30	709	739	0,41
800	703	733	0,41	863	893	0,50
1000	903	933	0,52	1032	1062	0,59
1200	1103	1133	0,63	1211	1241	0,69

## Diagonal beams

## Permitted abutments capacity

Beams inter-axis (mm)	S55/45B (kg)	S55/55B (kg)
600	4600	6500
900	4200	5800
1200	3700	4700
1500	3200	4100
1800	2900	3900
2100	2400	3200

Upright S55/45B

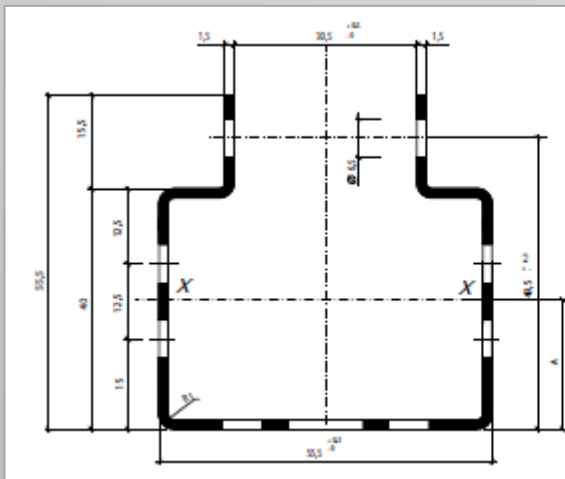

Upright S55/55B

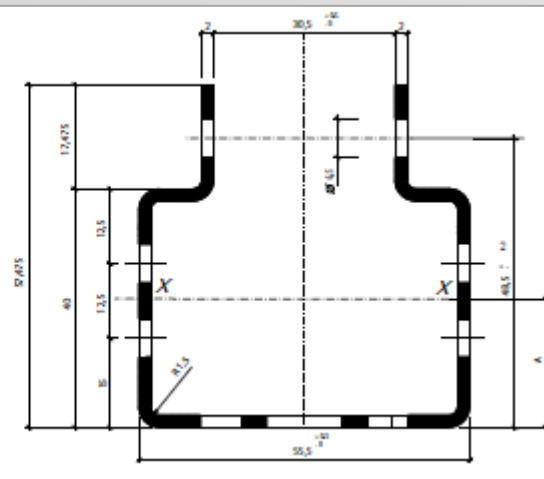

Cross and diagonal beam S55/45B and S55/55B

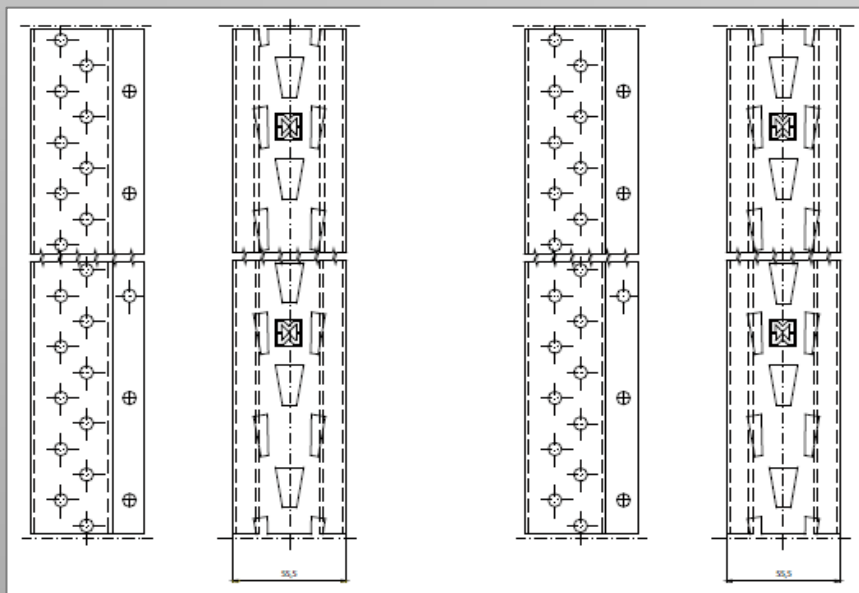
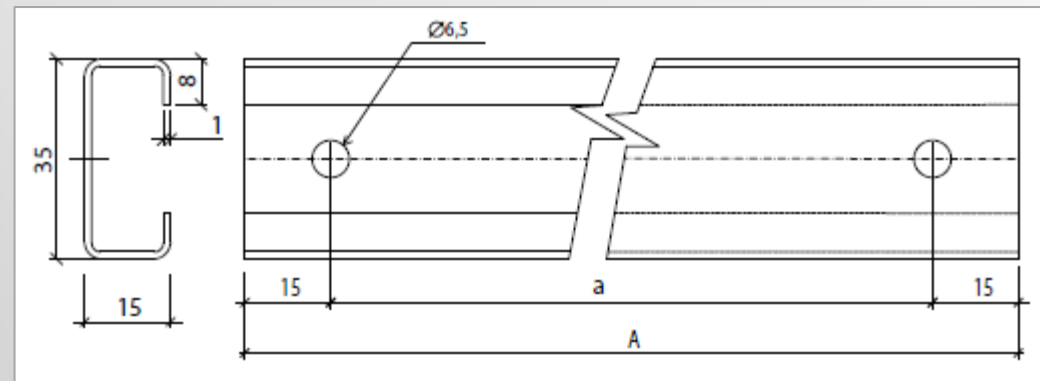

Scheme of cross and diagonal beams

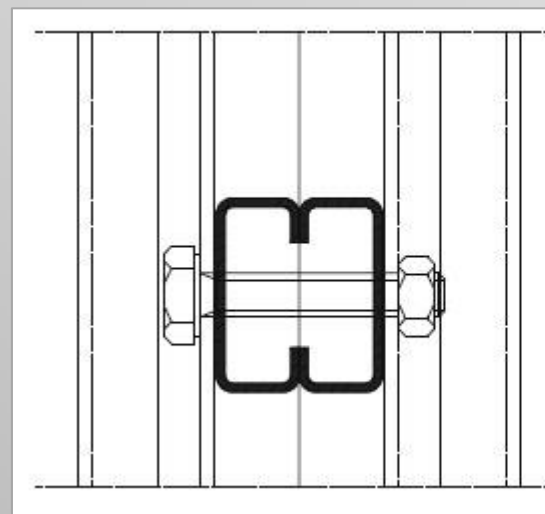

Cross beam terminal spacer

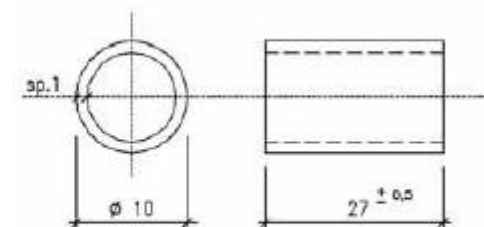

H = 2200 - 2700 - 3200 - 3700 - 4200 - 4700 - 5200 - 5700 - 6200 - 6700 - 7200 - 7700 - 8200

Simple base plate

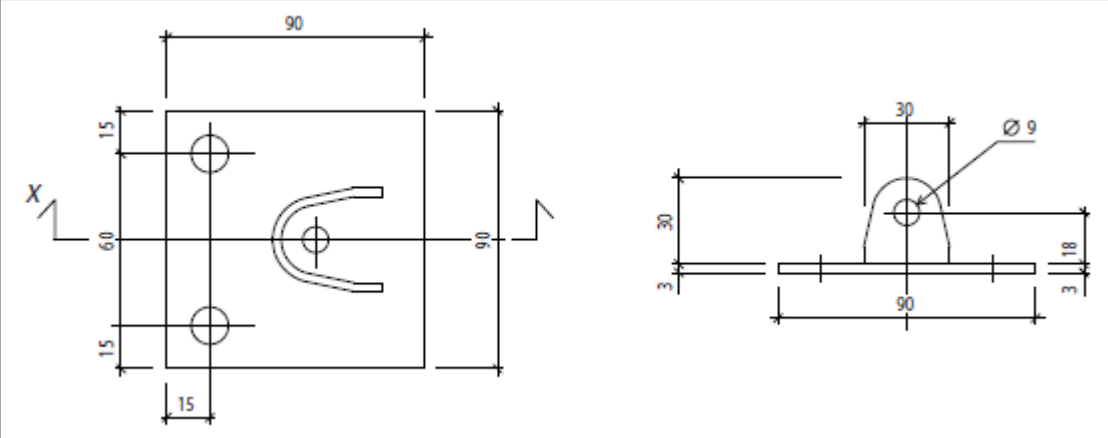

Base plate for installations

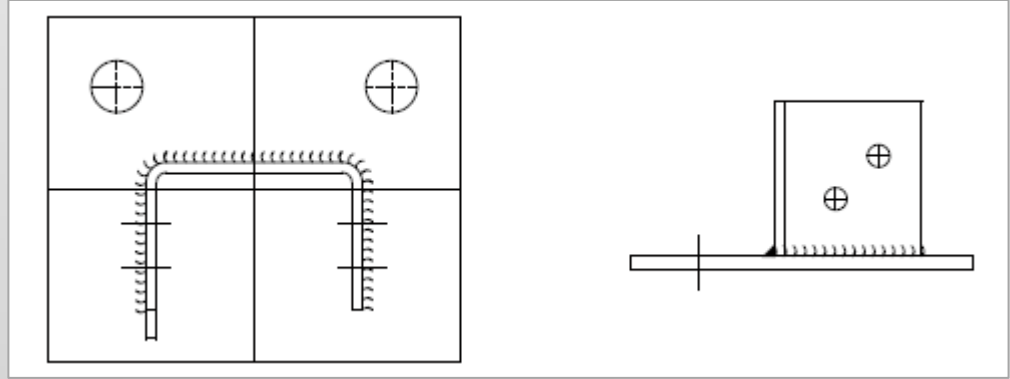

Wall anchor

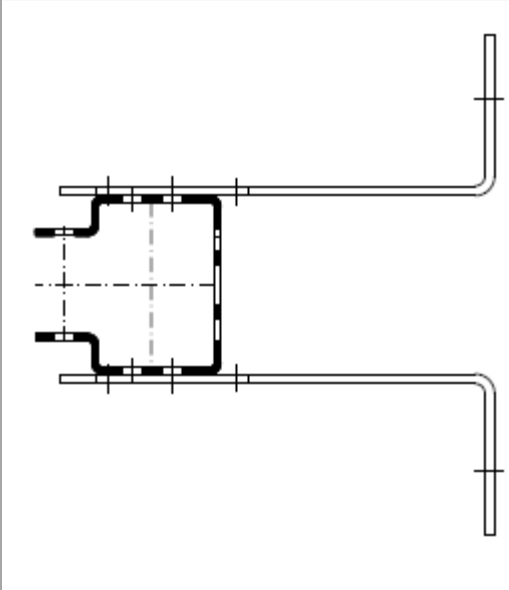

Beam stopper

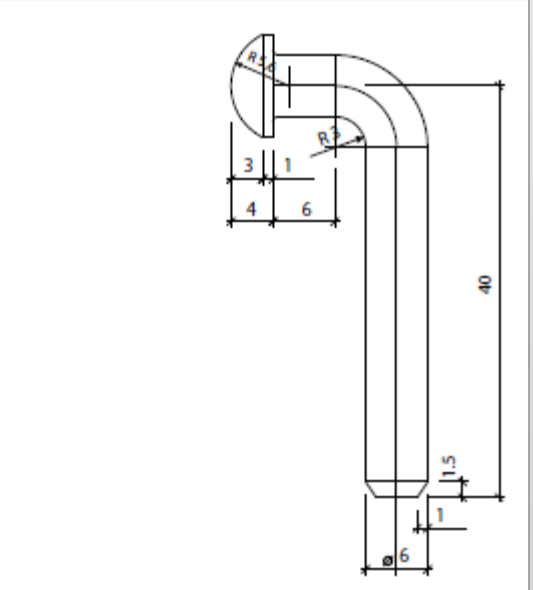

Beam thickness 1.5 mm

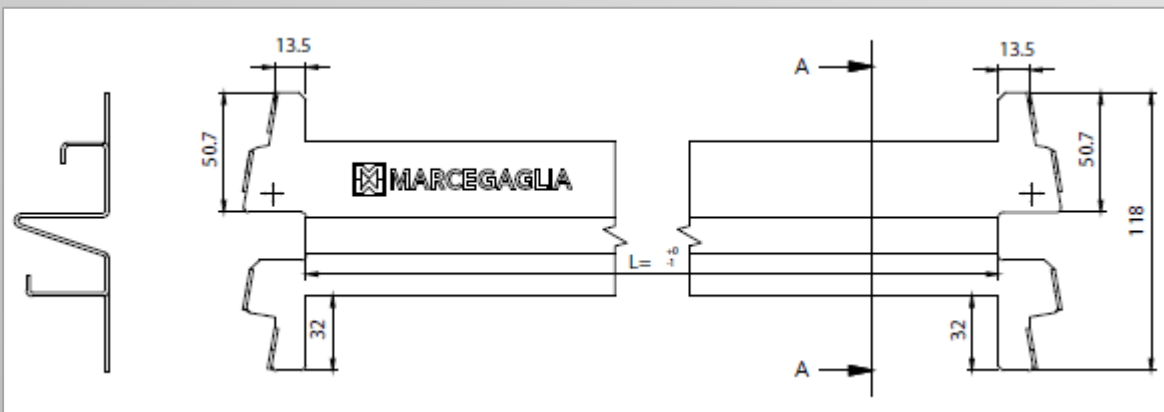

Standard beams for tiles 100 and 200 LBB

Normal length	Q load capacity kg
1200	800
1500	770
1800	600
2000	480
2400	320

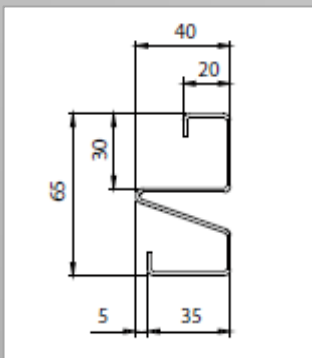

Standard beams for panels LBB 100-200-300

Code	Nominal length	L = mm	Q load capacity kg	Weigh kg
3681900915	1200	1205	800	2,72
3681901515	1500	1505	770	3,39
3681901715	1600	1605	740	3,61
3681902125	1800	1810	600	4,06
3681902525	2000	2010	480	4,50
3681902725	2100	2110	430	4,72
3681903325	2400	2410	320	5,39

## Tiles

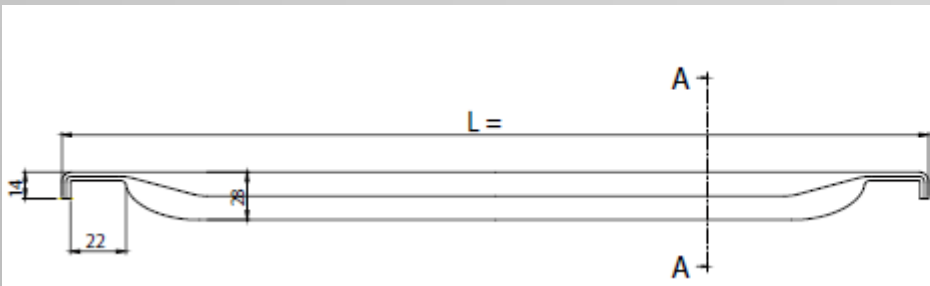

Tiles light Bi-Bloc thickness 0,6

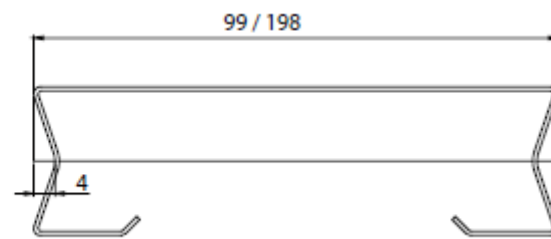

Tiles light Bi-Bloc thickness 0,6



Tiles 200 LBB	Load capacity kg. C.u.d.	Tiles 100 LBB	Load capacity kg. C.u.d.
200 x 400	130	100 x 400	130
200 x 500	115	100 x 500	115
200 x 600	100	100 x 600	100
200 x 800	80	100 x 800	80
200 x 1000	60	100 x 1000	60
200 x 1200	50	100 x 1200	50





We will welcome Your questions!

You can find us at

**[office@stamh.com](mailto:office@stamh.com)**

Further information

**[www.stamh.com](http://www.stamh.com)**

**STAMH Ltd.**, Ring Road, cross with 31 Yordan Bakalov Stubel Str.  
Sofia, Bulgaria